

A (Kumamoto-Jo Hall)

1F

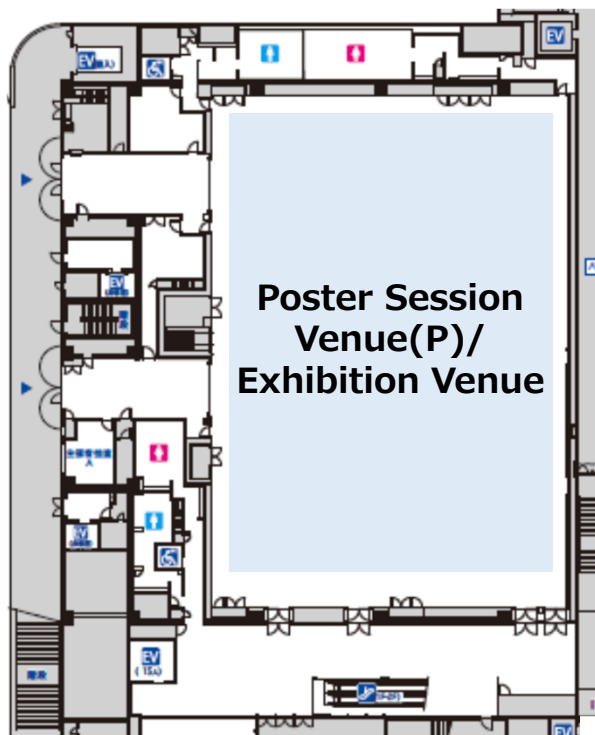

Information Desk
Hours 8 : 30~17 : 30
(On Sep. 23 until 13 : 00)

2F

Entrance is on the 2nd floor.

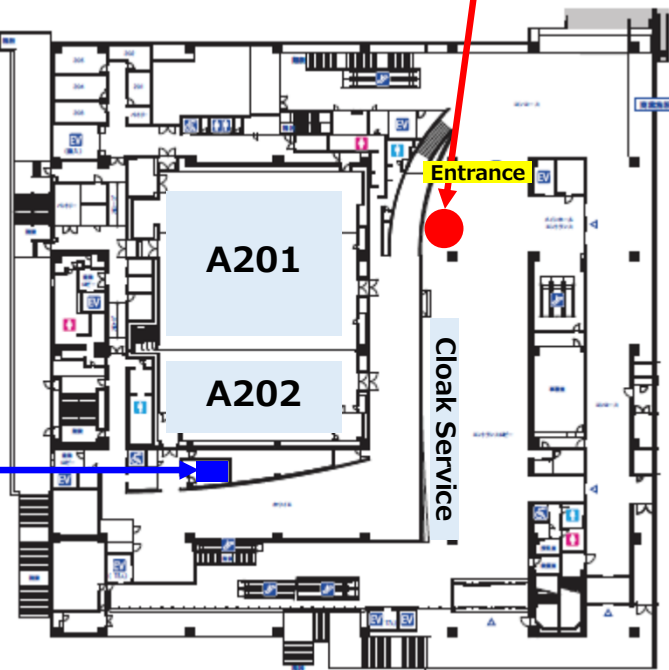

3F

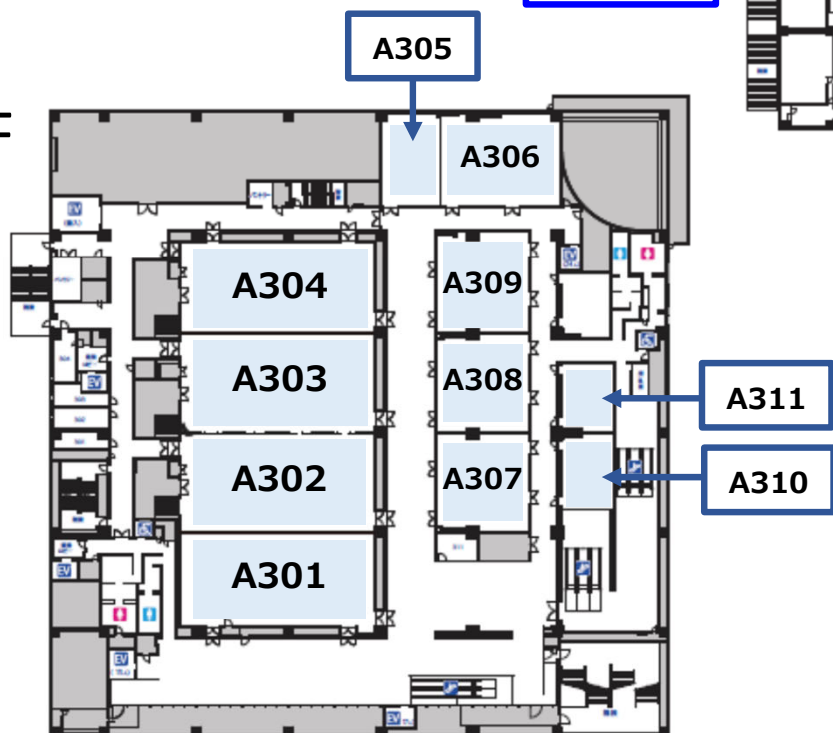

A (Kumamoto-Jo Hall)

4F

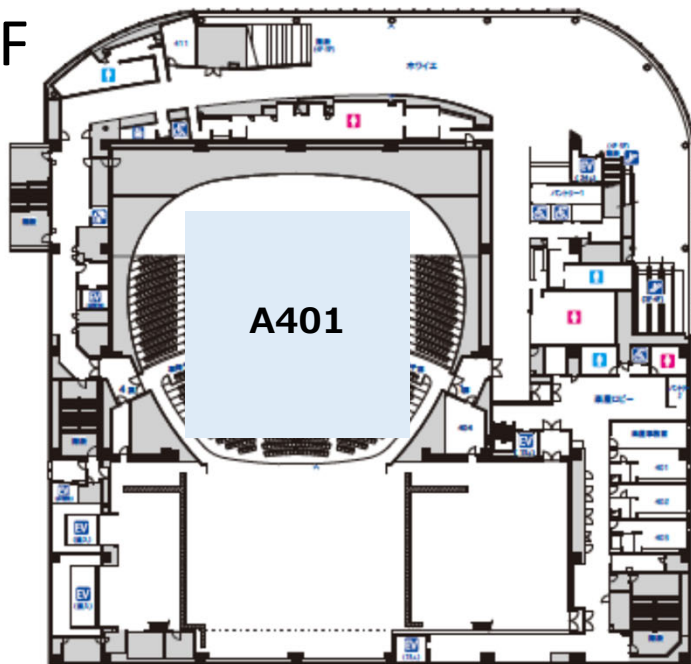

5F

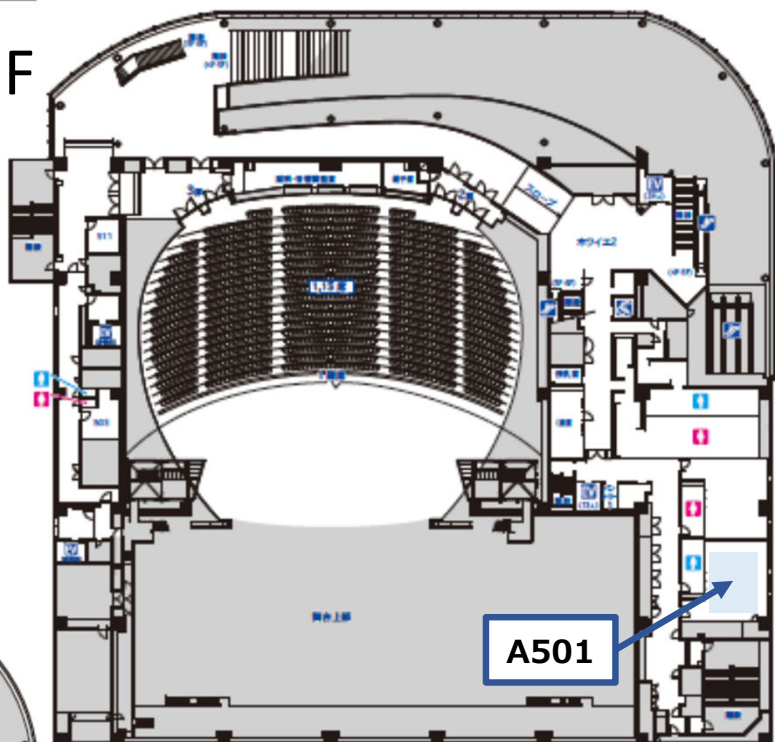

6F

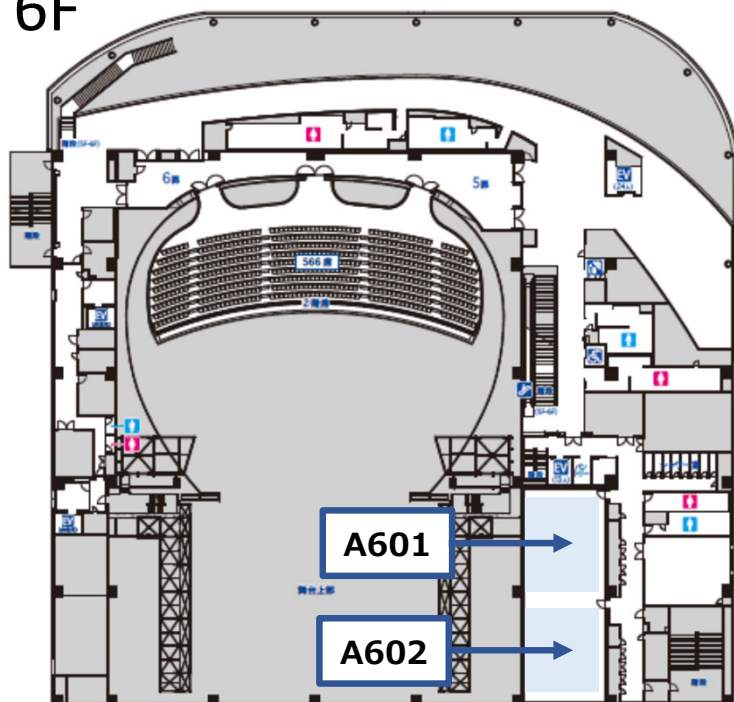

B (Civic Auditorium)

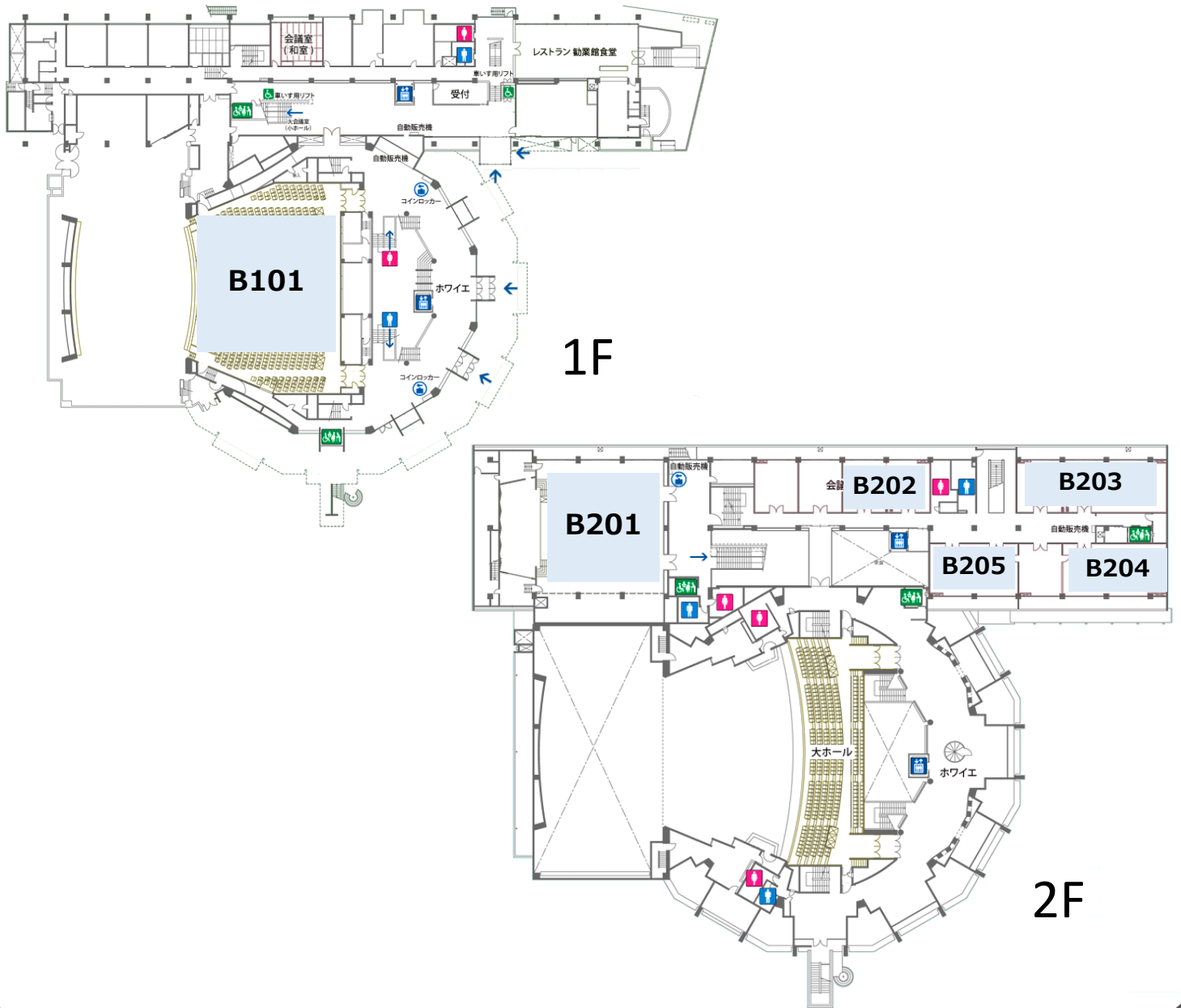

D (TKP Kumamoto Conference Center, Asahi Shimbun Daiichi Seimei Bldg.)

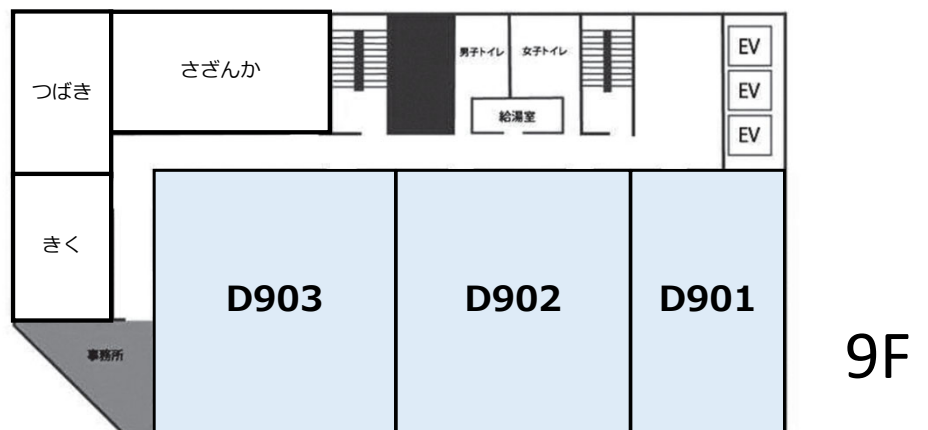

C (Kumamoto City International Center)

3F

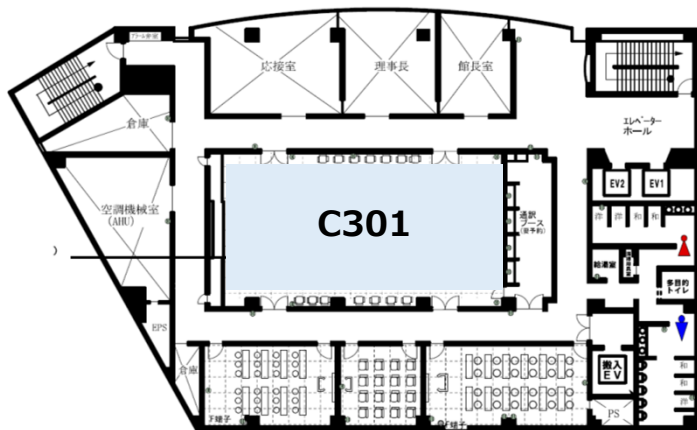

4F

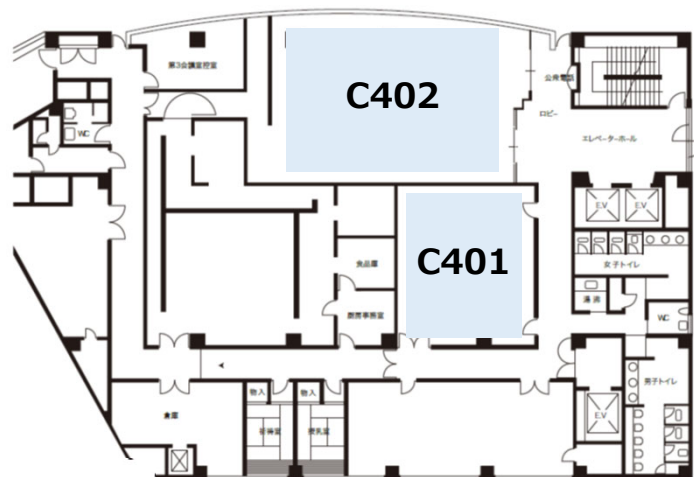

5F

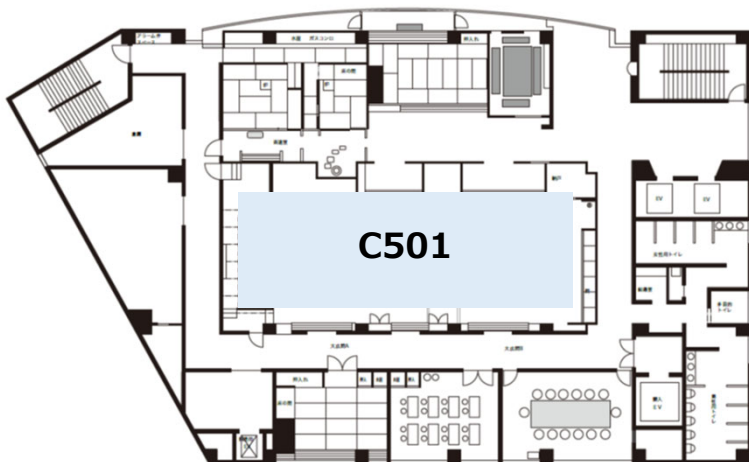

6F

